

# SPECIFICATIONS FOR GERSTUNG SUSPENDED FLOOR SYSTEM

A. The design: **AIRBASE® 200**

Single layered plywood subfloor to be suspended on 1-1/2" high Energy Blocks™, spaced to cover 2.41 blocks per square foot.

B. Specifications of component parts:

1. Energy Blocks™:

To consist of closed cell spring foam: Mill-R 6130 C type 2, grade B, medium to firm density 16 p.c.f., tensile strength 150 p.s.i., elongation 250%. Size 1-1/2" x 2 1/8" x 2 1/8" arranged to cover at least 2.41 blocks per square foot and adhered permanently to the underside of plywood. No cross linked polyethylene foam accepted. If other than "Gerstung" product, foam block compression test is required: maximum compression of 1/4" under 1,300 pounds distributed over 25 square feet area. After 168 hours permanent depression set is not to exceed 1/16th of an inch (2.15%).

2. Plywood:

Single layer of top grade plywood, Baltic or Finland Birch. Dimensions: 3'-11 1/4" x 3'-11 1/4", laminations should be 1/16th of an inch or less with an overall thickness of 12mm. Adjacent plywood sections shall be secured using 3/8" thick tab which spans the seam in order to create a solid 1/2" thick subfloor floating on thousands of Energy Blocks™.

C. Ramps:

The installation is to include ramps at \_\_\_ entry doors. Ramps shall be handicap/standard and will be approximately \_\_\_ feet in total length.

D. Installation:

The floor shall be installed using adhesives and installation techniques recommended by "Gerstung" floor designs. The flooring installer shall be certified by "Gerstung" as competent in the installation of foam block suspended athletic and dance floors.

# Air Base 200

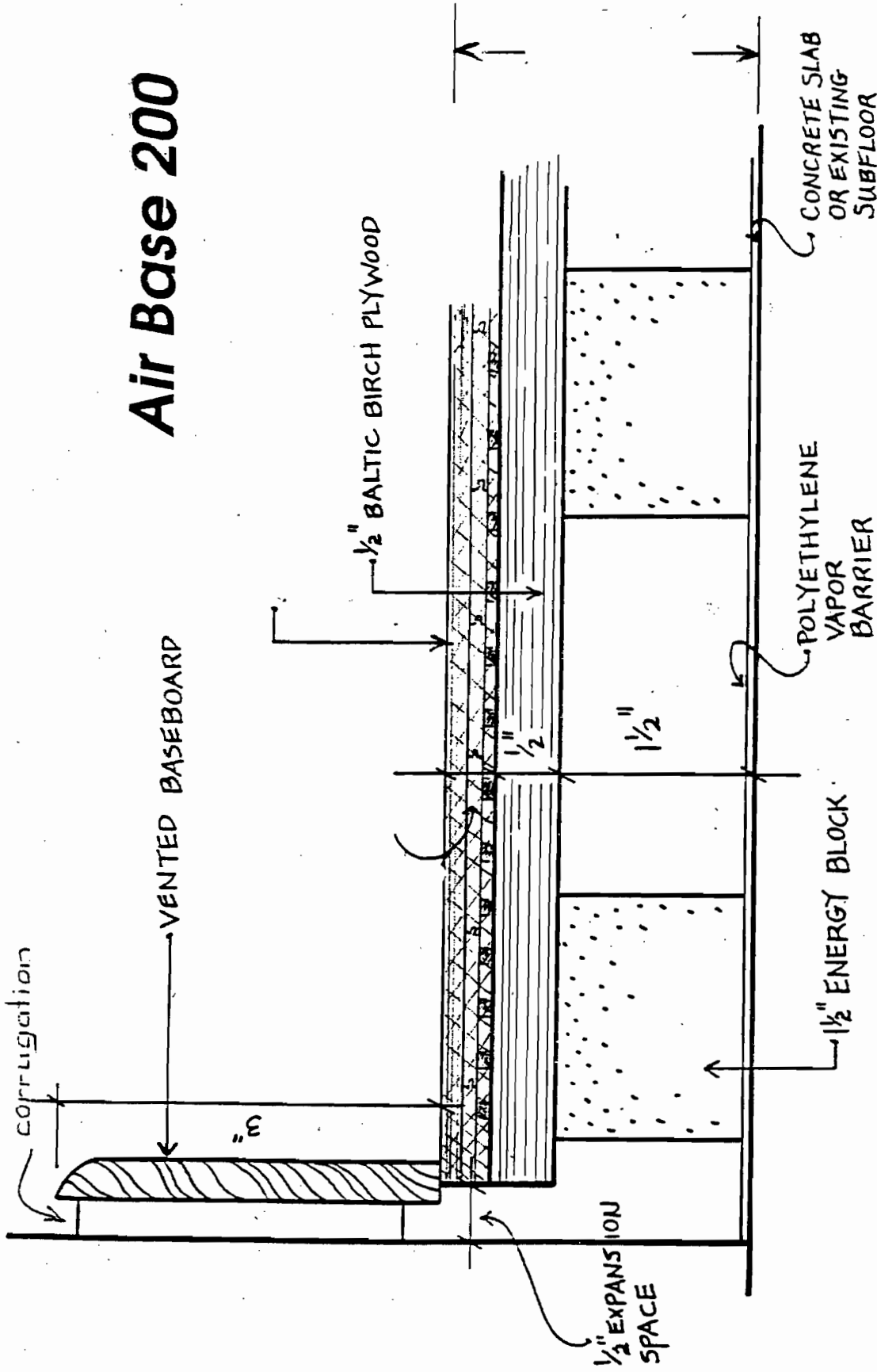

TYPICAL CROSS SECTION @ WALL