



gerstung
BALTIMORE, MARYLAND



SPECIFICATIONS FOR GERSTUNG SUSPENDED, FLOATING, RESILIENT FLOOR SYSTEM

A. The design: **AIRBASE® 100**

Two layered imported plywood sub-floor to be attached to 1 ½” high Energy Blocks™, spaced to cover 2.41 blocks per square foot.

B. Specifications of component parts:

1. Energy Blocks™:

To consist of closed cell "Energy" foam: Mill-R 6130 C type 2, grade B, medium to firm density 16 p.c.f., tensile strength 150 p.s.i., elongation 250%. Size 1 1/2" x 2 1/8" x 2 1/8" arranged to cover at least 2.41 blocks per square foot and adhered permanently to the underside of plywood. No cross linked polyethylene foam accepted. If other than "Gerstung" product, foam block compression test is required: maximum compression of 1/4" under 1,300 pounds distributed over 25 square feet area. After 168 hours permanent depression set is not to exceed 1/16th of an inch (2.15%).

2. Plywood:

Two layers of imported plywood 9 mm (3/8" +/-) thick, each to be glued and screwed in place in a staggered fashion creating a 18 mm (3/4" +/-) thick continuous subfloor, covering all of the intended area. Plywood is to be manufactured with multiple laminations, with an over all thickness of 9mm (3/8" +/-).

C. Installation:

The floor shall be installed using adhesives and installation techniques recommended by "Gerstung" Floor Systems. To maintain the warranty for installation "Gerstung" must install the floor system.

1400 Coppermine Terrace, Baltimore, Maryland 21209-2012 USA

Tel: (410) 337-7781 Fax: (410) 337-0471

www.gerstung.com

floors@gerstung.com

Air Base 100

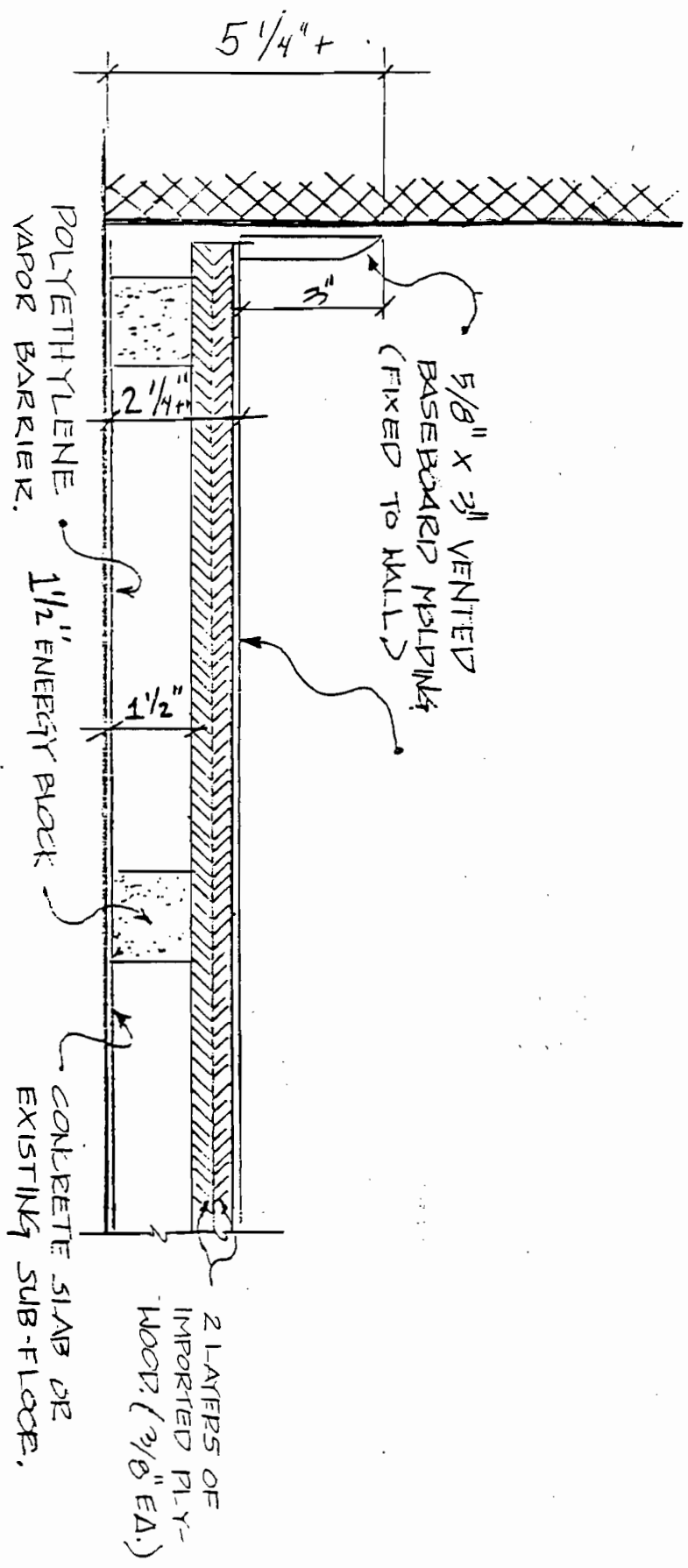

TYPICAL CROSS SECTION @ WALL

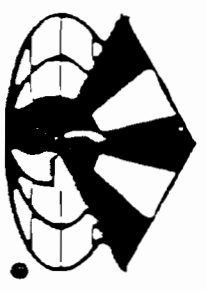

Gertsturng
FLOOR SYSTEMS[®]